



evolve
[WANTED
DESIGN]

avalon peyton

table of contents

concept statement	3
proposal statement	4
product partners	5
floor plans	6-7
interactive wall	8
takeaways	9
lighting	10-11
bar	12-13
rendering	14
biography	15



concept

evolve at WantedDesign Interiors takes inspiration from the evolution of a **golden hour**. A golden hour is something we have all experienced, whether in New York, Arizona, or somewhere in between.

The feeling of **change** and **transition** that the light of a golden hour brings to people is translated in the space with use of **materials**, **lighting** and **layout**.

proposal

evolve is a space that displays the products provided by the product partners in an **unconventional** and **avant-garde** manner. Carpets are displayed on walls and the HUSH lights act as wall separators instead of the lights they were designed to be. Because of this, people are able to admire and be inspired by these materials without seeing them in their usual locations. This is a **space that changes as the fair progresses**. A heat sensitive material on the bar and table tops change color when touched with cold cups or warm hands. An interactive wall will **mimic the golden light and experience of a golden hour**, which changes as the fair goes on. Pieces of the wall are encouraged to be taken off and used as coasters. When the coasters are removed, the SHAW contract desert lights carpet is revealed. This involves the user with the **evolution of the space** which draws people in. These branded coasters act as the take aways and will remind the users of the space every time they use them.

product partners



ressource paint



emeco broom
chair:
orange, white



shaw contract:
desert lights
collection



hush light

floorplan

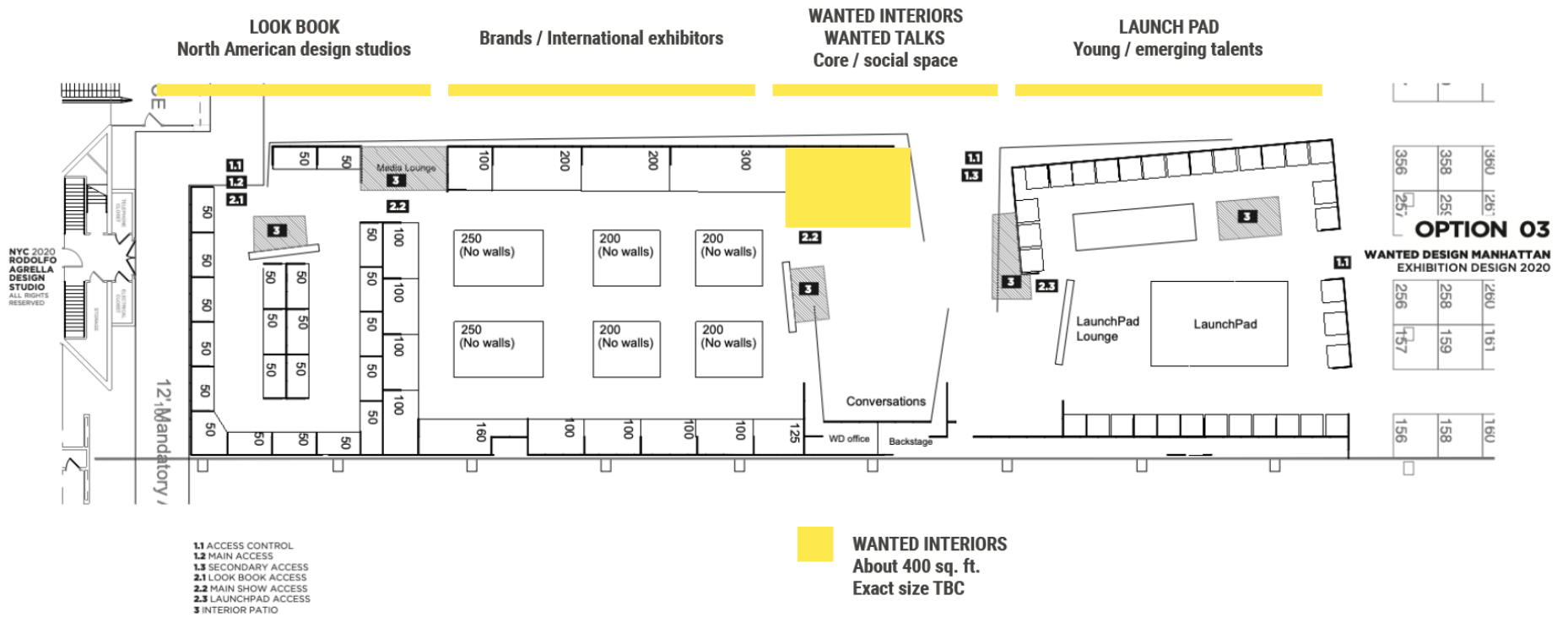

callout

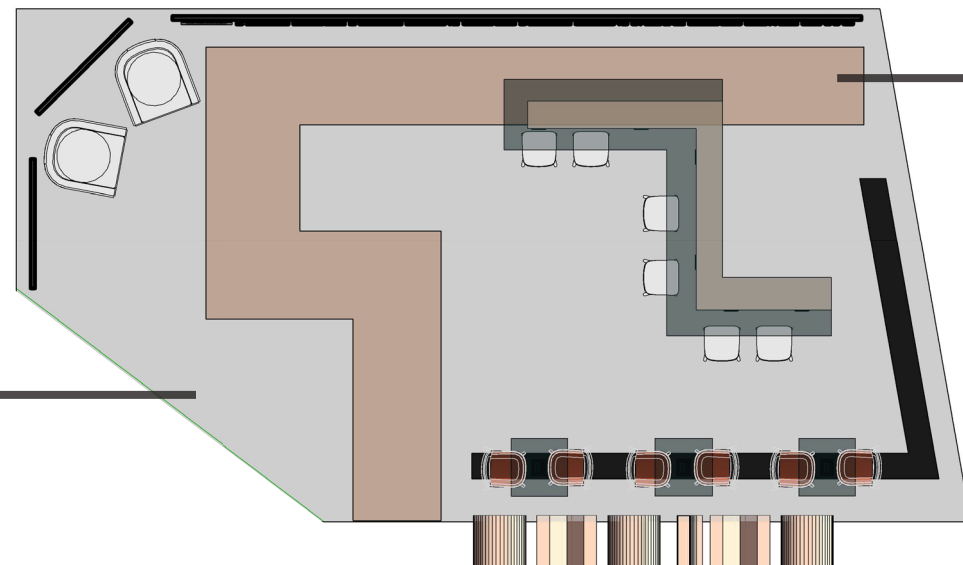
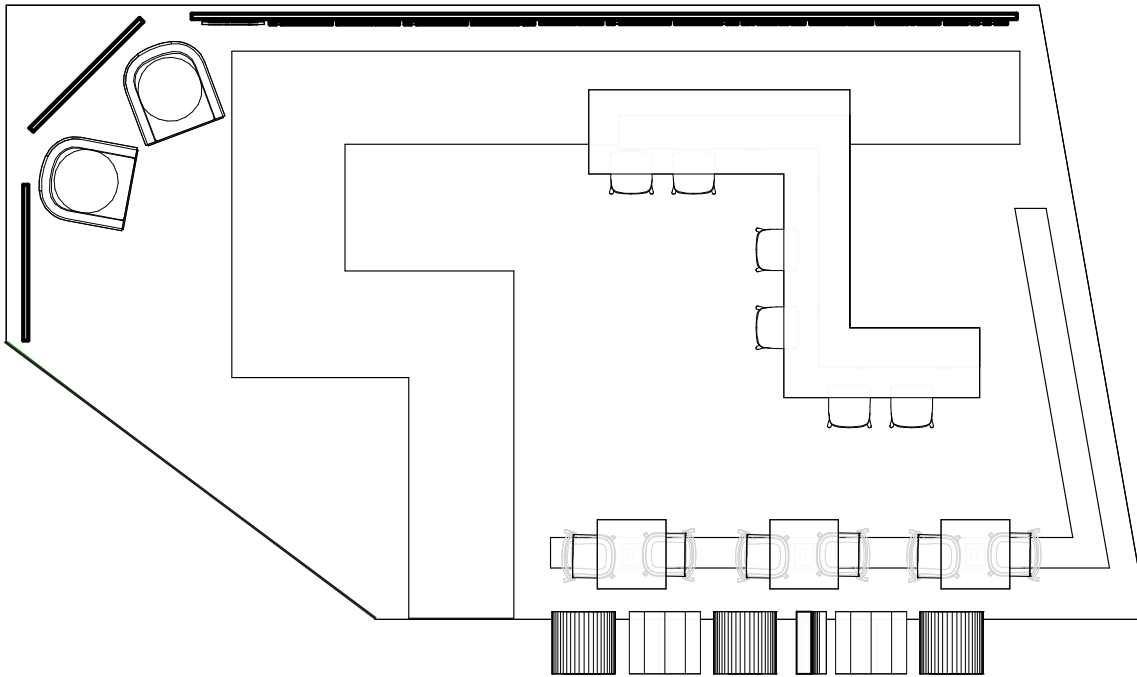

interactive wall

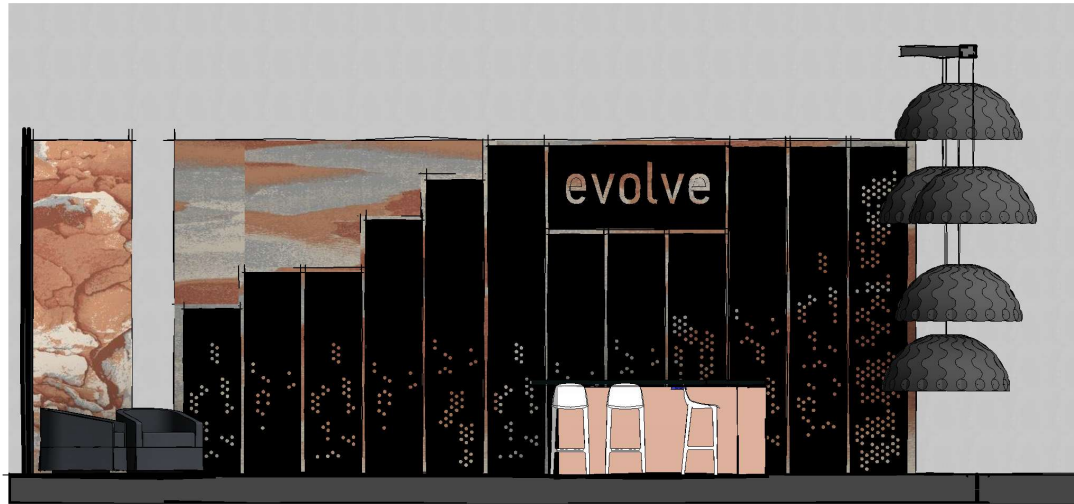

This interactive wall is suspended by the ceiling while also being supported with a rod and base system with panels and fasteners.

Coasters are removed from the wall by visitors and bartenders, revealing the Desert Lights carpet behind it.

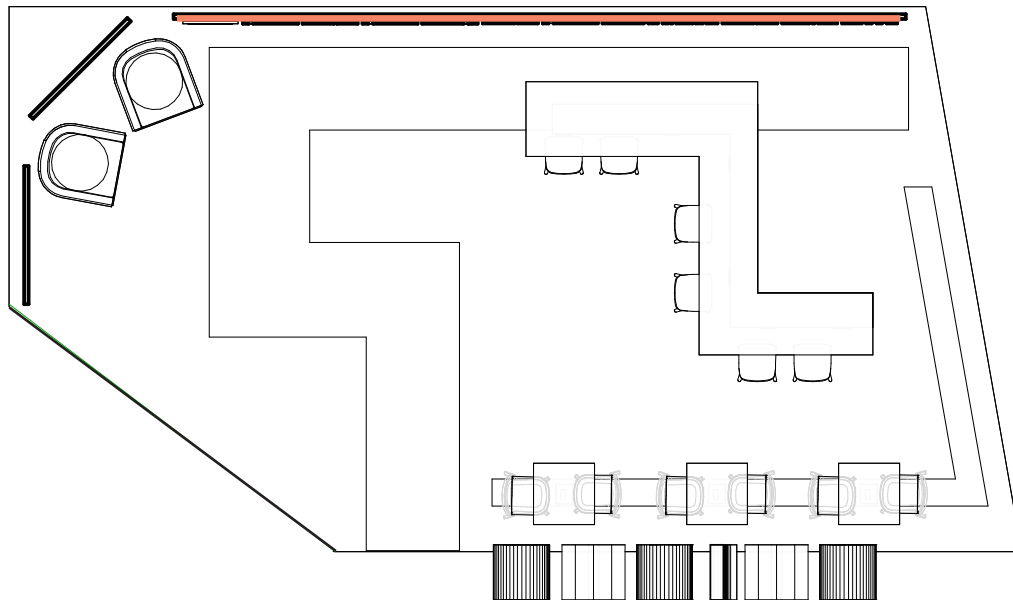

coasters



evolve

[WANTED
DESIGN]

product partners:

haworth: HUSH light
emeko: broom chair
ressource

The coasters are lasercut circles of wood coated with a black paint in order to disguise themselves within the interactive wall

rcp

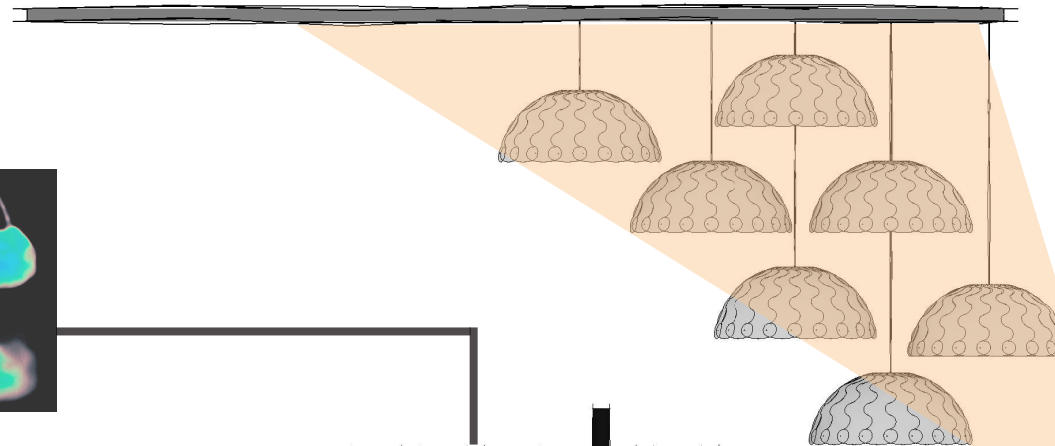
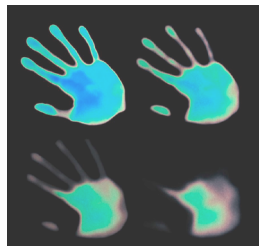
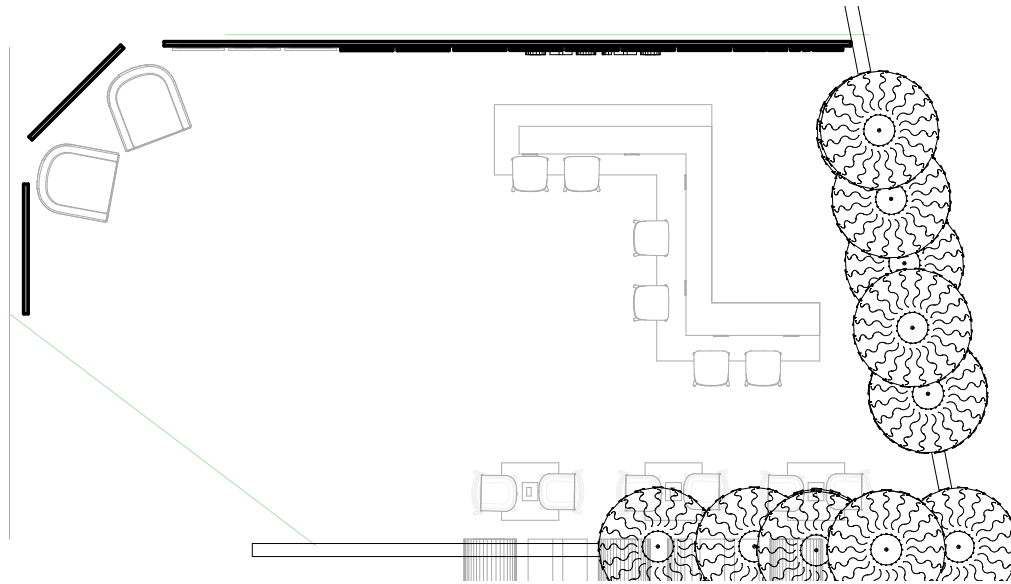

HUSH wall is
illuminated using
an external source

evolve

lighting



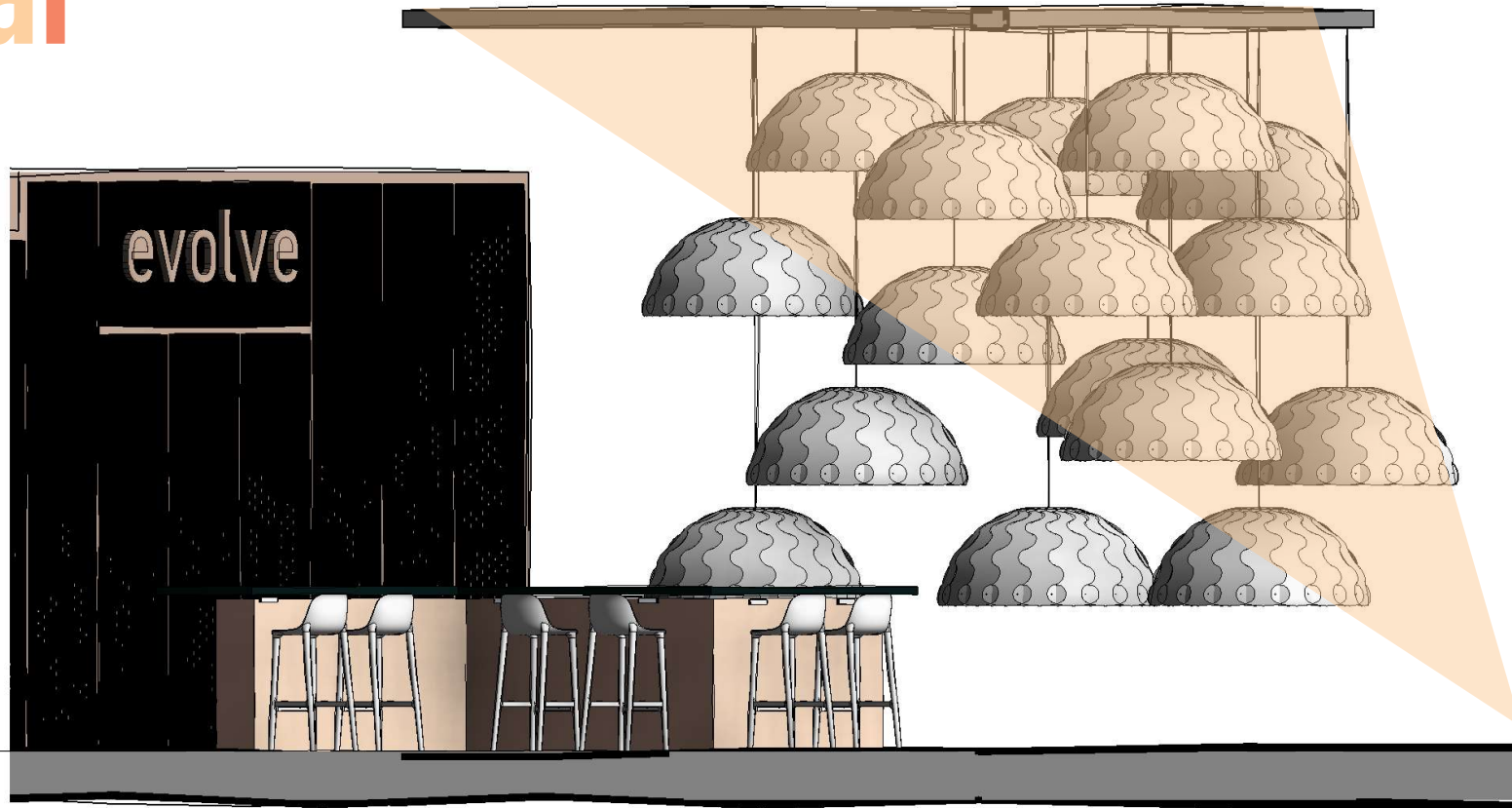

This centralized bar is meant to be a place of serenity in the chaotic setting in which it takes place. The Liquid Crystal sheet material on the bar and table tops change color when they come in contact with cold cups or warm hands.

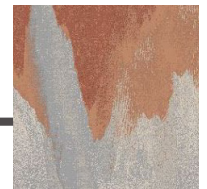
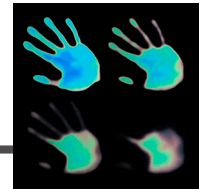

perspective





the designer

"I am excited and beyond grateful to be able to contribute to **WantedDesign Interiors** because it is such a great opportunity to learn, network, and be inspired by the work of the most successful designers in the world."

avalon peyton

A thick yellow L-shaped graphic consisting of a horizontal line at the top and a vertical line on the left, forming a corner.

thank you

[WANTED
DESIGN]

avalon peyton